



We provide superior performing compressed air & gas systems with engineered longevity to reduce operating costs and improve productivity.



Shreeyansh Enterprises :9899611990, 9650491991



## ENGINEERED FOR SUPERIOR PERFORMANCE

*Air Control Unit / Quick Coupler / Air Hose / Air Gun*



[www.airpipe.in](http://www.airpipe.in)

Instamod Air Pipe Pvt. Ltd.  
709, Shahpuri Tower, C-58, Janakpuri  
New Delhi-110058. Tel : 011-49535588  
Email : [sales@airpipe.in](mailto:sales@airpipe.in), [santosh.kumar@airpipe.in](mailto:santosh.kumar@airpipe.in)





# Because we CARE ...

Today, we help more than 4000 customers worldwide to reduce operating costs in their production, and we are committed to minimize the pollution & safety risks wherever our products are used. Every year, we keep upgrading our products to help our customer to improve their productivity.

Customer covers automobile manufacturing, tobacco, wine, electronics, food, machinery, cosmetics and so on.



# Engineered for Superior Performance

*Your Air Line Connectivity*



## ► Energy loss through air distribution

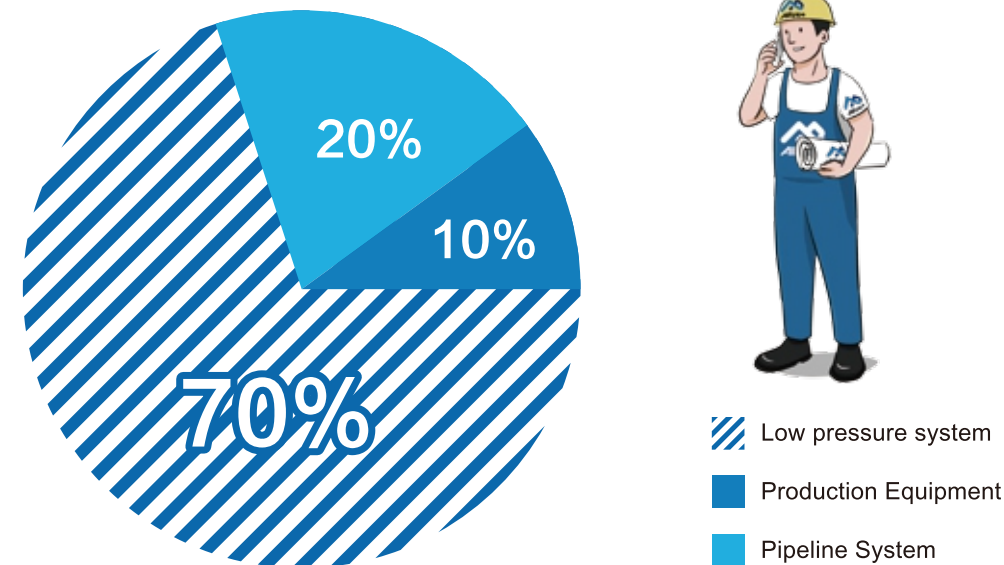

Through on-site investigation of thousands customers, we found 90% has air leakage issue, and more than 70% of this leakage is happening at low pressure system – the point of use part. The waste of energy cost is amazing!

## ► Cost calculation of the energy waste caused by the low pressure leakage in the compressed air system

<p>8m<sup>3</sup> flow of compressed air will be produced at 7bar with the power input of 1kw</p> <p>That equals to 1kwh to produce 8 m<sup>3</sup> flow of compressed air.</p> <p><b>Assumption:</b> 1kwh = 0.1USD</p>	<p>At 7bar, the leakage would be 3.48m<sup>3</sup>/h caused by the hole of Dia.1mm</p>	<p>Every year the leakage would be:</p> $3.48 \text{ m}^3/\text{h} \times \frac{6000 \text{ hours}}{(250 \text{ days} \times 24 \text{ h})} = 20880 \text{ m}^3$ $\frac{20880 \text{ m}^3/\text{year}}{8 \text{ m}^3/\text{kw}} = 2610 \text{ kw/year}$
-----------------------------------------------------------------------------------------------------------------------------------------------------------------------------------------------------------------------------	----------------------------------------------------------------------------------------	---------------------------------------------------------------------------------------------------------------------------------------------------------------------------------------------------------------------------------------------------------

## ► Superior performance

- Push button system**  
 Easy recognized, color of the button shows the fitting standard.
- Optimized air flow**  
 Guarantee the max power rate of pneumatic system and air tools.
- Perfect sealing**  
 The top perfectly closes to the inside of the fittings (plug contour, NBR sealing ring) to make sure the tight air seal.
- Silicon free**  
 In order not to pollute the compressed air during the process (such as painting or varnish), the silicon should be avoided completely in the production and the assembling process.
- Scratch resistance**  
 The joint body is made of composite materials, in order not to damage the fragile surface. (vehicle body production, furniture, computer hardware)
- Anti-static**  
 Premium conductivity design, away from electrostatic phenomena.
- Smooth design**  
 Designed to make sure the quick and convenient grab of the fitting during operation.
- Light weight, compact design**  
 The small size of the fitting makes the operation precise and less effort.
- Rigid body**  
 The fitting body is made of composite materials with strong mechanical characteristics. Resistance to wear, collision, crush, corrosion.
- Easy connection**  
 Quick and easy to change the tools.
- Rotatable fitting body**  
 Rotatable fitting body makes the button can be pushed in any position.
- Perfect compatibility**  
 Compatible with all main standards (ISO B, ISO-C, 7.2MM etc)

## ► Safety

- The built-in safety**  
 Pressure relief device is built in to avoid any safety accident when pulling out the adaptor or breaking the connection. To disconnect, you just need to press the button to relieve the pressure of downstream and disconnect. The fitting complies with ISO 4414 and DIN EN 983.
- ATEX 94/9/CE regulation**  
 ATEX 2 confirms usage in most industries (gas environment, grain transmission, spraying room). AIRpipe fitting is considered to be integrated into the system, free of any ignition risk. Can be used in below certified equipments:
  - Group II
  - Category 2
  - ATEX group GD
  - ATEX nature IIB
- Application**  
 AIRpipe can be used in the entire system, air supply hose or the compressed air distribution in the fixed working station, or straight connection (tool, air gun and spray gun). The inner diameter of the fitting depends on the air demand.







**Content**

**NO.1**  
Quick coupler series **07**

**NO.2**  
Air hose series **18**

**NO.3**  
Air gun series **24**

**NO.4**  
F.R.L. air control unit **29**

**NO.5**  
Push Fittings **37**



# NO.1 Quick coupler series



## Features

- Push button technology
- Special treatment steel material
- Compressed air
- Shock resistance
- Adapt to harsh environment
- High air flow
- Low pressure drop

## Application

- Directly connect to the tools
- Heavy industry
- Steel & iron plant
- Mining
- Construction



## (JAPANESE) STYLE - REGULAR TYPE

PART NO.	SIZE			PART NO.	SIZE
IAP17SHA	1/4" HOSE			IAP17PHA	1/4" HOSE
IAP20SHA	5/16" HOSE			IAP20PHA	5/16" HOSE
IAP30SHA	3/8" HOSE			IAP30PHA	3/8" HOSE
IAP40SHA	1/2" HOSE			IAP40PHA	1/2" HOSE
IAP20SFA	1/4"			IAP10PFA	1/8"
IAP30SFA	3/8"			IAP20PFA	1/4"
IAP40SFA	1/2"			IAP30PFA	3/8"
IAP20SMA	1/4"			IAP40PFA	1/2"
IAP30SMA	3/8"			IAP10PMA	1/8"
IAP40SMA	1/2"			IAP20PMA	1/4"
IAP20SPA	5X8mm hose			IAP30PMA	3/8"
IAP30SPA	6.5X10mm hose			IAP40PMA	1/2"
IAP40SPA	8x12mm hose			IAP20PPA	5X8mm hose
				IAP30PPA	6.5X10mm hose
				IAP40PPA	8x12mm hose

\* COMPATIBLE WITH NITTO

## ► Features

- 1 One-way automatic shut-off valve in the socket.
- 2 Wide variety provides best choice accordingly to application.
- 3 Hardened important parts are extremely wear resistant and durable.
- 4 Tested 100,000times, coupler connection is accurate and reliable.

## ► Application

- 1 Pneumatic tools
- 2 Air Piping
- 3 Air pressure equipment

## ► Specification

MATERIAL	STAINLESS STEEL	STEEL
Working Pressure	15 Bar (1.5MPa)	
Max. Pressure	20Bar (2 Mpa)	
Temperature Range	-20°C~+80°C	
Size	1/4" (20Type)	
	3/8" (30Type)	
	1/2" (40Type)	



### JAPANESE STYLE - HIGH FLOW TYPE

PART NO.	SIZE			PART NO.	SIZE
IAP 400SHA	1/2" HOSE			IAP 400PHA	1/2" HOSE
IAP 600SHA	3/4" HOSE			IAP 600PHA	3/4" HOSE
IAP 800SHA	1" HOSE			IAP 800PHA	1" HOSE
IAP 400SFA	1/2"			IAP 400PFA	1/2"
IAP 600SFA	3/4"			IAP 600PFA	3/4"
IAP 800SFA	1"			IAP 800PFA	1"
IAP 400SMA	1/2"			IAP 400PMA	1/2"
IAP 600SMA	3/4"			IAP 600PMA	3/4"
IAP 800SMA	1"			IAP 800PMA	1"

\* COMPATIBLE WITH NITTO

#### ► Features

- 1 One-way automatic shut-off valve in the socket.
- 2 Wide variety provides best choice accordingly to application.
- 3 Hardened important parts are extremely wear resistant and durable.
- 4 Tested 100,000times, coupler connection is accurate and reliable.

#### ► Application

- 1 Pneumatic tools
- 2 Air Piping
- 3 Air pressure equipment

#### ► Specification

MATERIAL	STAINLESS STEEL	STEEL
Working Pressure	15 Bar (1.5MPa)	
Max. Pressure	20Bar (2 Mpa)	
Temperature Range	-20°C~+80°C	
Size	1/2" (400Type)	
	3/4" (600Type)	
	1" (800Type)	

### NORTH AMERICA STYLE, UNIVERSAL 1/4" BODY, AUTOMATIC 3 IN 1

PART NO.	SIZE			
IAP S27-20MA	1/4"NPT			S21 Truflate Type
IAP S27-30MA	3/8"NPT			
IAP S27-20SFA	1/4"NPT			S22 Aro Type
IAP S27-30SFA	3/8"NPT			
IAP S27-20SHA	1/4"Hose			S25 Industrial Type
IAP S27-25SHA	5/16" Hose			
IAP S27-30SHA	3/8" Hose			

#### ► Features

- 1 1/4" body design for Industrial/Milton, Automotive/Tru-Flate, and ARO Interchange.
- 2 For and Six stainless steel locking balls design as option Automatic design.

#### ► Application

- 1 Pneumatic tools
- 2 Air Piping
- 3 Air pressure equipment

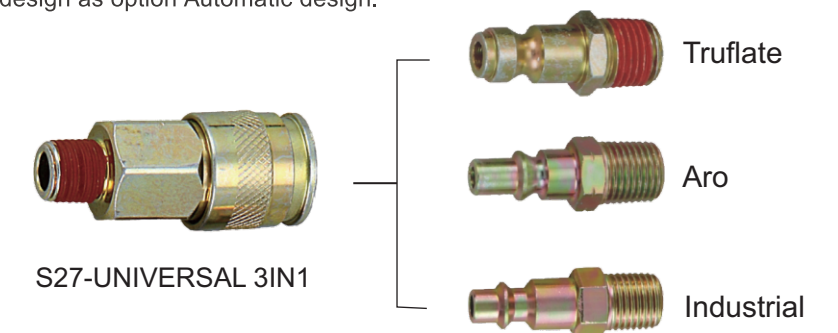









#### ► Specification

MATERIAL	STAINLESS STEEL	STEEL
Thread	NPT	
Working Pressure	15Bar(1.5MPa)	10Bar(1MPa)
Max. Pressure	20 BBar(2MPa)	15 BBar(1.5MPa)
Temperature Range	-20°C~ +80°C	
Size	1/4"(20 TYPE)	
	3/8"(30 TYPE)	



## EUROPEAN STYLE, UNIVERSAL 3 IN 1

PART NO.	SIZE			PART NO.	SIZE
IAP S31-20SMA	1/4" G			IAP S31-20PMA	1/4" G
IAP S31-30SMA	3/8" G			IAP S31-30PMA	3/8" G
IAP S31-40SMA	1/2" G			IAP S31-40PMA	1/2" G
IAP S31-20SFA	1/4" G			IAP S31-20PFA	1/4" G
IAP S31-30SFA	3/8" G			IAP S31-30PFA	3/8" G
IAP S31-40SFA	1/2" G			IAP S31-40PFA	1/2" G
IAP S31-20SPA	5X8mm			IAP S31-20PPA	5X8mm
IAP S31-30SPA	6.5x10mm			IAP S31-30PPA	6.5x10mm
IAP S31-40SPA	8x12mm			IAP S31-40PPA	8x12mm
IAP S31-20SHA	1/4" HOSE			IAP S31-20PHA	1/4" HOSE
IAP S31-25SHA	5/16" HOSE			IAP S31-25PHA	5/16" HOSE
IAP S31-30SHA	3/8" HOSE			IAP S31-30PHA	3/8" HOSE
IAP S31-40SHA	1/2" HOSE			IAP S31-40PHA	1/2" HOSE

### ► Features

- 1 Universal type fit for the most popular interchanges including Orion, Milton and ARO
- 2 Easy to connect
- 3 Automatic design
- 4 Interchangeable with RECTUS 25KB series

### ► Application

- 1 Pneumatic tools
- 2 Air Piping
- 3 Air pressure equipment

### ► Specification

MATERIAL	STEEL	COPPER
Thread	G	
Working Pressure	15Bar(1.5MPa)	
Max. Pressure	20Bar(2MPa)	
Temperature Range	-20°C~ +80°C	

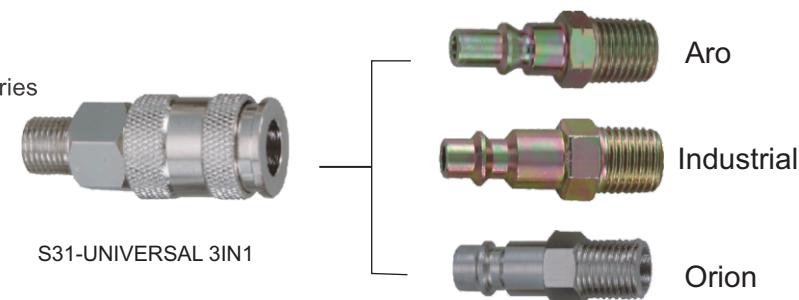

## EUROPEAN STYLE

PART NO.	SIZE			PART NO.	SIZE
IAP S33-20SMA	1/4"G			IAP S31-20PMA	1/4"G
IAP S33-30SMA	3/8"G			IAP S31-30PMA	3/8"G
IAP S33-40SMA	1/2"G			IAP S31-40PMA	1/2"G
IAP S33-20SFA	1/4"G			IAP S31-20PFA	1/4"G
IAP S33-30SFA	3/8"G			IAP S31-30PFA	3/8"G
IAP S33-40SFA	1/2"G			IAP S31-40PFA	1/2"G
IAP S33-20SHA	1/4" HOSE			IAP S31-20PHA	1/4" HOSE
IAP S33-30SHA	3/8" HOSE			IAP S31-25PHA	5X16" HOSE
IAP S33-40SHA	1/2" HOSE			IAP S31-30PHA	3/8" HOSE
				IAP S31-40PHA	1/2" HOSE

\* COMPATIBLE WITH RECTUS 26KB

### ► Features

- 1 G thread (Germany Type) Interchange
- 2 Automatic Design
- 3 Compatible with ORION, MILTON and RECTUS 26KB series

### ► Application

- 1 Pneumatic tools
- 2 Air Piping
- 3 Air pressure equipment

### ► Specification

MATERIAL	STEEL	COPPER
Thread	G	
Working Pressure	15Bar(1.5MPa)	
Max. Pressure	20Bar(2MPa)	
Temperature Range	-20°C~ +80°C	
Size	1/4" (20 TYPE)	
	3/8" (30 TYPE)	
	1/2" (30 TYPE)	



## EUROPEAN STYLE, SAFETY COUPLER

PART NO.	SIZE			PART NO.	SIZE
IAPS34-20SMB	1/4" G			IAPS03-20PMA	1/4" G
IAPS34-30SMB	3/8" G			IAPS03-30PMA	3/8" G
IAPS34-40SMB	1/2" G			IAPS03-40PMA	1/2" G
IAPS34-20SFB	1/4" G			IAPS03-20PFA	1/4" G
IAPS34-30SFB	3/8" G			IAPS03-30PFA	3/8" G
IAPS34-40SFB	1/2" G			IAPS03-40PFA	1/2" G
IAPS34-20SHB	ID.6mm			IAPS03-20PHA	ID.6mm
IAPS34-25SHB	ID.8mm			IAPS03-25PHA	ID.8mm
IAPS34-30SHB	ID.9mm			IAPS03-30PHA	ID.9mm
IAPS34-35SHB	ID.10mm			IAPS03-35PHA	ID.10mm
IAPS34-40SHB	ID.13mm			IAPS03-40PHA	ID.13mm

### ► Features

- 1 Two steps release function to prevent operational injury while pull out from fittings.







### ► Application

- 1 Pneumatic tools
- 2 Air Piping
- 3 Air pressure equipment

### ► Specification

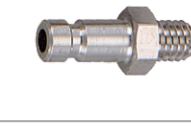
MATERIAL	STEEL
Thread	G
Working Pressure	15Bar(1.5MPa)
Max. Pressure	20Bar(2MPa)
Temperature Range	-20°C~ +80°C
Size	1/4" (20 TYPE)
	3/8" (30 TYPE)
	1/2" (30 TYPE)

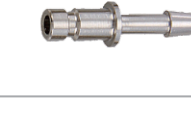
## EUROPEAN STYLE, RECTUS 20KA

PART NO.	SIZE			PART NO.	SIZE
IAP SE01-05SFB	M5			IAP SE01-05PFB	M5
IAP SE01-10SFB	1/8"			IAP SE01-10PFB	1/8"
IAP SE01-05SMB	M5			IAP SE01-05PMB	M5
IAP SE01-10SMB	1/8"			IAP SE01-10PMB	1/8"
IAP SE01-10SHB	ID.3mm			IAP SE01-10PHB	ID.3mm
IAP SE01-20SHB	ID.4mm			IAP SE01-20PHB	ID.4mm
IAP SE01-10SPB	4X3mm			IAP SE01-10PPB	4X3mm
IAP SE01-20SPB	5X3mm			IAP SE01-20PPB	5X3mm
IAP SE01-30SPB	6X4mm			IAP SE01-30PPB	6X4mm

\* COMPATIBLE WITH RECTUS 20KA

### ► Features

- 1 One side sealing, one touch quick release with extremely small dimensions and high pass at low pressure drop.

### ► Application

- 1 Pneumatic tools
- 2 Air Piping
- 3 Air pressure equipment

### ► Specification

MATERIAL	COPPER
Thread	G
Working Pressure	10Bar(1MPa)
Max. Pressure	15Bar(1.5MPa)
Temperature Range	-20°~ +80°
Size	M5 (05 TYPE)
	1/8" (10 TYPE)



## EUROPEAN STYLE,ORION BRASS COUPLER

PART NO.	SIZE			PART NO.	SIZE
IAP SE05-20SFB	1/4"G			IAP SE05-20SHB	ID.6mm
IAP SE05-30SFB	3/8"G	IAP SE05-25SHB	ID.8mm		
IAP SE05-40SFB	1/2"G				
IAP SE05-40SMB	1/4"G		IAP SE05-30SHB	ID.9mm	
IAP SE05-30SMB	3/8"G				
IAP SE05-40SMB	1/2"G				
IAP SE05-40SMB	1/2"G				IAP SE05-40SHB

\* COMPATIBLE WITH ORION

### ► Features

- 1 One touch operation, rapid action with needle lock and non-return valve coupling with a high flow rate. A robust body for big pneumatic consumer.

### ► Application

- 1 Pneumatic tools
- 2 Air Piping
- 3 Air pressure equipment

### ► Specification

MATERIAL	COPPER
Thread	G
Working Pressure	10Bar(1MPa)
Max. Pressure	15Bar(1.5MPa)
Temperature Range	-20°~ +80°
Size	1/4" (20 TYPE)
	3/8" (30 TYPE)

## MANIFOLD



IAP SMV



IAP SMY



IAP SML



IAP SMT



IAP SMM



IAP SMX

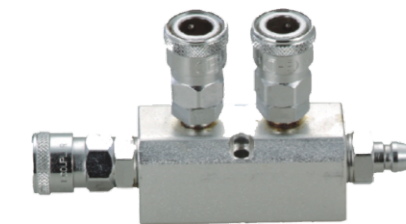

IAP SM2BA



IAP SM3BA

DESCRIPTION	PART NO.	IAP SMVA SMLA SMMA SMYA SMTA SMXA	IAP SMVA SMLT SMMT SMYT SMTT SMXT	IAP SM2BA SM3BA SM4BA SM5BA
	Body		Aluminum	
Coupler		Steel	One Touch	Steel
Working Pressure		15Bar(1.5MPa)		
Maximum Pressure		20Bar(2MPa)		
Temperature Range		-20°C~ +80°C		
Port Size		1/4"		1/2"



### MANIFOLD BODY

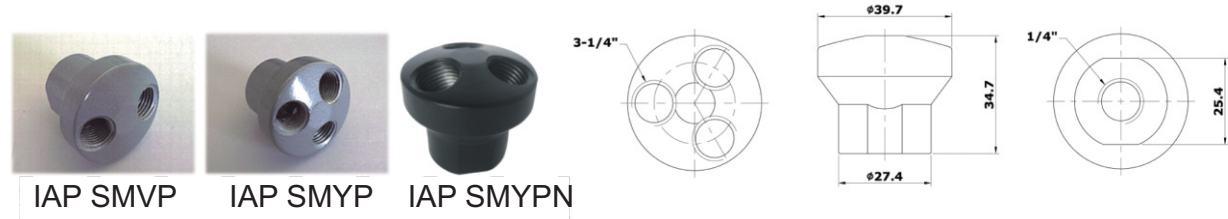

IAP SMVP IAP SMYP IAP SMYPN

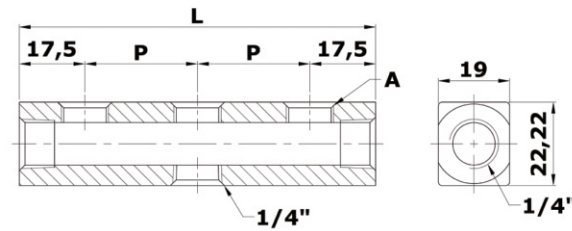
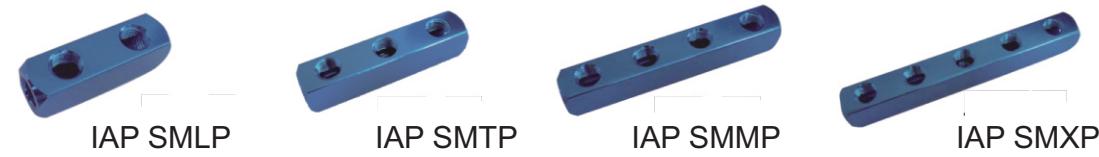

PART NO.	A	P	L
IAP SMLP	2	30X1	65
IAP SMTP	3	30X2	95
IAP SMMP	4	30X3	125
IAP SMXP	5	30X4	155



IAP SM2BP

IAP SM3BP

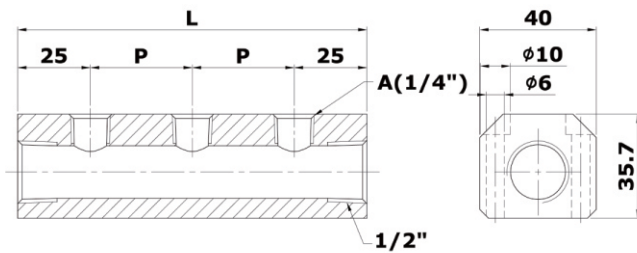

PART NO.	A	P	L
IAP SM2BP	2	35X1	85
IAP SM3BP	3	35X2	120
IAP SM4BP	4	35X3	155
IAP SM5BP	5	35X4	190

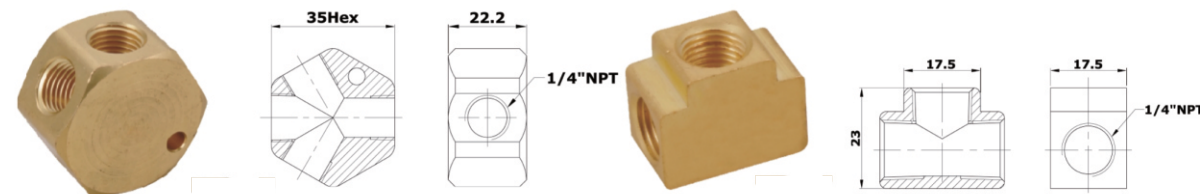

IAP JA122N

IAP JA092N

# NO.2 Air hose series



### HUB

- Enhanced PVC
- Anti-UV treatment
- Application: general purpose that needs air

### HUBR

- The flexibility of the workplace
- Polyurethane tube
- Fluid: compressed air
- Anti-shock
- Wear-resistance
- Distortion resistance
- Small bending radius
- Excellent shape memory
- Straight at the end
- Paint treatment, Rotary screw
- Application: Industry, Vehicle maintenance, gas station, Convenient store, School, etc

### HUS

- Polyurethane and PVC
- Wear resistance and very soft
- Application: Compressed air, oil, gasoline and solvent



## PU HOSE

PART NO.	I.D(mm)	O.D(mm)	LENGTH	TEMPERATURE	WORKING PRESSURE
IAP HUS2504	2.5	4	200M	-20°C ~ 60°C (-5°F ~ +140°F)	150PSI (1MPa)
IAP HUS0406	4	6	200M		
IAP HUS0508	5	8	100M		
IAP HUS6510	6.5	10	100M		
IAP HUS0812	8	12	100M		
IAP HUS1014	10	14	50M		
IAP HUS1216	12	16	50M		
IAP HUS651095135	9.5	13.5	50M		

PART NO.	I.D(mm)	O.D(mm)	LENGTH	TEMPERATURE	WORKING PRESSURE
IAP HUS104160	1/4"	0.16"	100	-20°C ~ 60°C (-5°F ~ +140°F)	150PSI
IAP HUS516187	5/16"	0.187"	100		150PSI
IAP HUS308250	3/8"	0.25"	50		150PSI
IAP HUS102320	1/2"	0.32"	50		150PSI
IAP HUS916375	9/16"	0.375	50		150PSI

Standard Color: ●RD ●OR ●YL ●GN ●BS ●BK

### ► Features

- 1 Super mechanical strength and excellent abrasive resistance
- 2 Superior heat and cold resistance
- 3 Oil resistance
- 4 Light weight
- 5 Could accept customer-made (packing, or length and can connect with different fitting or coupler)



## PU BRAID AIR HOSE

PART NO.	I.D(mm)	O.D(mm)	LENGTH	TEMPERATURE	WORKING PRESSURE
IAP HUB0508	5	8	100M	-20°C ~60°C (-5°F ~ +140°F)	200PSI (1.33MPa)
IAP HUB6510	6.5	10	100M		
IAP HUB0812	8	12	100M		
IAP HUB1014	10	14	50M		
IAP HUB1216	12	16	50M		
IAP HUB95135	9.5	13.5	50M		

PART NO.	I.D(mm)	O.D(mm)	LENGTH	TEMPERATURE	WORKING PRESSURE
IAP HUB516187	5/16	0.187	100	-20°C ~60°C (-5°F ~ +140°F)	200PSI
IAP HUB308250	3/8	0.25	100		200PSI
IAP HUB102320	1/2	0.32	100		200PSI
IAP HUB916375	9/16	0.375	50/100		200PSI

### ► Features

- 1 Light weight
- 2 High flexibility even under 0°degree temperature
- 3 High durability
- 4 Could accept customer-made (packing, or length and can connect with different fitting or coupler)





## PU RECOILED AIR TUBE

PART NO.	I.D(mm)	O.D(mm)	LENGTH	TEMPERATURE	WORKING PRESSURE
IAP HUB0508	5	8	9/12/15	-20°C ~60°C (-5°F ~ +140°F)	200PSI
IAP HUB6510	6.5	10			200PSI
IAP HUB0812	8	12			200PSI
IAP HUB95135	9	13.5			200PSI
IAP HUB1014	10	14			200PSI
IAP HUB1216	12	16			200PSI

PART NO.	I.D(mm)	O.D(mm)	LENGTH	TEMPERATURE	WORKING PRESSURE
IAP HUB516187	5/16	0.187	15/20	-20°C ~60°C (-5°F ~ +140°F)	200PSI
IAP HUB308250	3/8	0.25			200PSI
IAP HUB102320	1/2	0.32			200PSI
IAP HUB916375	9/16	0.375			200PSI

### ► Features

- 1 Light weight
- 2 High flexibility even under 0°degree temperature
- 3 High durability
- 4 Could accept customer-made (packing, or length and can connect with different fitting or coupler)



## AIR HOSE REEL



PART NO.	HOSE SIZE (mm)	LENGTH (M)	HOSE COLOR	HOSE
IAP HR01050810U	5X8	10	BLUE	PU Braid Hose
IAP HR01050812U	5X8	12	BLUE	PU Braid Hose
IAP HR01651010U	6.5X10	10	BLUE	PU Braid Hose
IAP HR01081208U	8X12	8	BLUE	PU Braid Hose



PART NO.	HOSE SIZE (mm)	LENGTH (M)	HOSE COLOR	HOSE
IAP HR0302U	1/4"	15	BLUE	PU Braid Hose
IAP HR0325U	5/16"	15	BLUE	PU Braid Hose
IAP HR0303U	3/8"	12	BLUE	PU Braid Hose



PART NO.	HOSE SIZE (mm)	LENGTH (M)	HOSE COLOR	HOSE
IAP HR0608 1230U-BD	8X12mm	30	BLUE	PU Braid Hose
IAP HR0665 1030U-BD	6.5X10mm	30	BLUE	PU Braid Hose



## AIR HOSE REEL IN STEEL CASE



PART NO.	HOSE SIZE (mm)	LENGTH (M)	HOSE COLOR	HOSE
IAP HR072550U	5/16"	50/15	BLUE	PU Braid Hose
IAP HR070340U	3/8"	40/12	BLUE	PU Braid Hose
IAP HR070350U	3/8"	50/15	BLUE	PU Braid Hose

### ► Features

- 1 Steel case enhanced
- 2 Prone to be installed on wall and ceiling
- 3 190° rotatable
- 4 High quality spring design can be rolled back & forth effectively .  
Double rolling test: 30,000 times  
Double-hole design on the handlebars is convenient to be fixed and installed

## HAND CRANK HOSE REEL



PART NO.	HOSE SIZE (mm)	LENGTH (M)	HOSE COLOR	HOSE
IAP HR082530U	5/16"	100/30	BLUE	PU Braid Hose
IAP HR080320U	3/8"	65.6/20	BLUE	PU Braid Hose

### ► Features

- 1 Light weight and easy to carry for the furniture and the wood material decoration cost efficiency

# NO.3 Air gun series



### Features

- Ergonomics design
- Adjustable air flow
- Scratch resistance
- Built in brass thread
- Anti-shock
- Standard metal nozzle
- Complies with OSHA standard big flow nozzle
- Complies with OSHA standard mute nozzle
- Gas nozzle (Anti dust & debris)
- Standard composite materials nozzle

### Application

- Industries of various size
- Vehicle maintenance plant and gas station
- Paint and vehicle factory
- School etc



## AIR GUNS



B-90

B-91

B-93

### ► Specification

PART NO.	PORT SIZE	NOZZLE LENGTH	NOZZLE OD	MAX. PRESSURE	AIR FLOW
IAP B90	1/4" G	5CM	Φ 8mm	15Bar (213psi/1.5Mpa)	1200L/M @150psi
IAP B91		25CM			
IAP B93		12CM			

### ► Features

- ① Steel reinforced inlet.
- ② Light weight and durable.
- ③ High flow: flow higher than standard >1200L/M@150PSI.
- ④ Long life time: top-down valve structure design, less wear of spring, longer lifetime.

## AIR GUNS

PART NO.  
IAP B90C-07

Low noise air gun (OSHA)

PART NO.  
IAP B90C-12

Centralized nozzle air gun (OSHA)

PART NO.  
IAP B90C-14

Adjustable nozzle air gun (OSHA)

PART NO.  
IAP B90C-20

High flow nozzle air gun (OSHA)

PART NO.  
IAP B93E

12CM-Long nozzle and 8mm air gun

PART NO.  
IAP B90E

Rubber nozzle air gun



## HIGH FLOW AIR GUN



### ► Specification

BODY MATERIAL	ALUMINUM
Max Working Pressure	16Bar (1.6MPa)
Air Flow	1500 L/m @10 kgf/cm <sup>2</sup>
Port Size (G)	3/8"

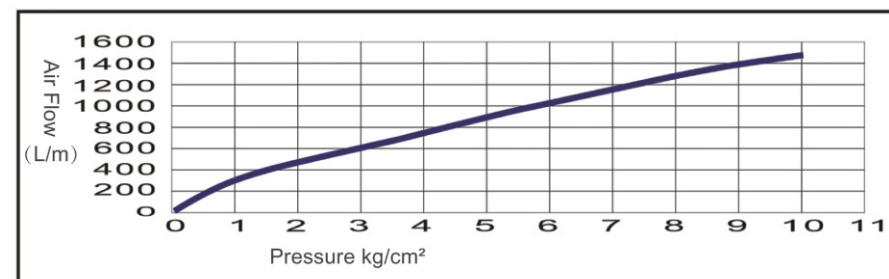

### ► Features

- 1 Different length nozzles for different purpose.
- 2 Aluminum body light weight and durable.
- 3 Maximum flow for easy clean-up and blow off of even the heaviest shavings and chips.
- 4 Meets or exceed OSHA regulations.

## HIGH FLOW AIR GUN

PART NO.
IAP B60

Low noise air gun ( OSHA )

PART NO.
IAP B60A

Adjustable nozzle air gun ( OSHA )

PART NO.
IAP B60B

Centralized nozzle air gun ( OSHA )

PART NO.
IAP B60C

High flow nozzle air gun ( OSHA )

# NO.4 F.R.L. air control unit



## Features

- Anti-vibration
- Air filter, regulator and lubricator
- Port size from 1/8" to 2 1/2"
- Filter precision: 25u - 0.01u
- Quick and easy to assemble

## Application

- Air treatment for end use point
- Pneumatic tools
- Compressed air supplied to mechanics
- Automation etc



## FRL20/IAPC20



IAP F20



IAP R20



IAP L20



IAP FR20



IAP FRL20



IAP C20

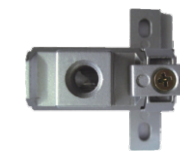

IAP C20-AS 1  
C20-Manifold

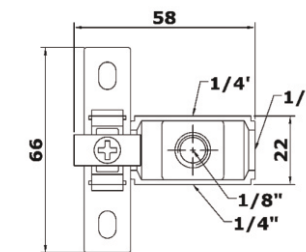

Branch connection frame

## 20 SERIES DRAWING

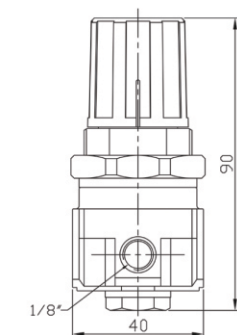
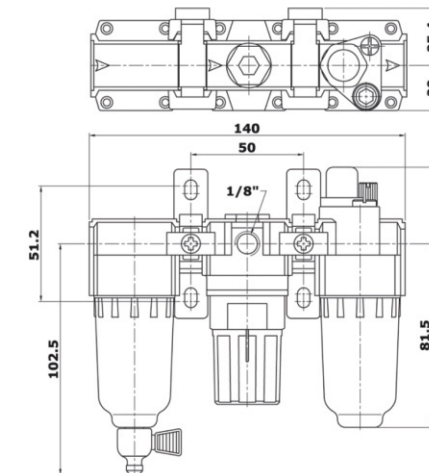
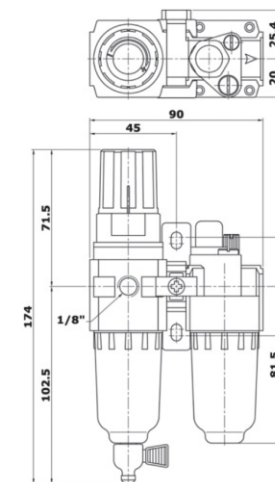



► **Specification**

PART NO.		IAP C201	IAP C202	IAP FRL212
DESCRIPTION		IAP FRL201	IAP FRL202	
Medium		Air		
Port Size (G)		1/8"	1/4"	1/4"
Filter Element		5µ		
Max Input Pressure	Psi	150		280
	Mpa	1		2
Max Output Pressure	Psi	7 - 140		7 - 227
	Mpa	0.05-0.96		0.05 - 1.6
Max Flow (L/min)		1000	1100	1100
Operation Temperature Range		5 ~ 60°C		
Drain Capacity		15ml		
Oil Capacity		30ml		
Recommendable Lubricants		ISO VG-32		
<b>MORE OPTIONS</b>				
Air Filter		IAP F201	IAP F202	IAP F212
Regulator		IAP R201	IAP R202	IAP R212
Air Filter+Regulator		IAP FR201	IAP FR202	IAP FR212
Lubricator		IAP L201	IAP L202	IAP L212

► **Order information**

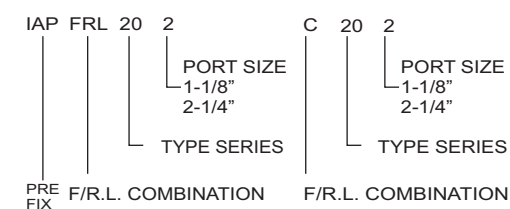

► **Features**

- 1 Compact design for limited space.
- 2 Easy installation
- 3 Cost effective



Semi-Auto Drain Valve

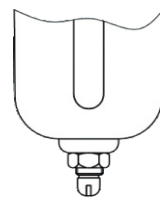

Manual Drain Valve

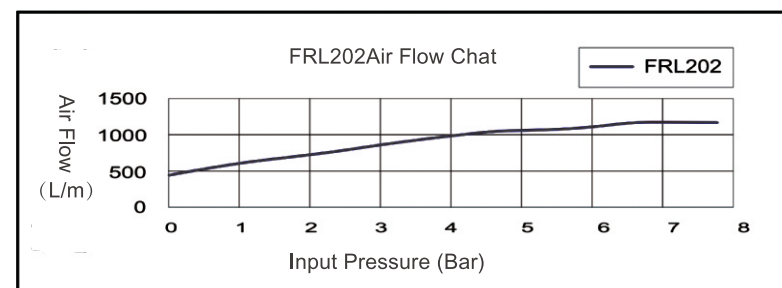

**FRL50/IAPC50**



IAP C50-AS1  
IAP C50-Manifold

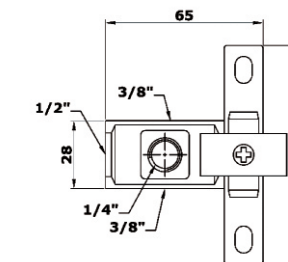

**50 SERIES DRAWING**

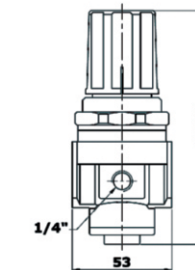
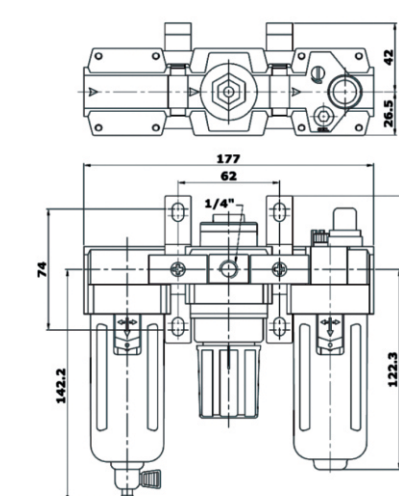
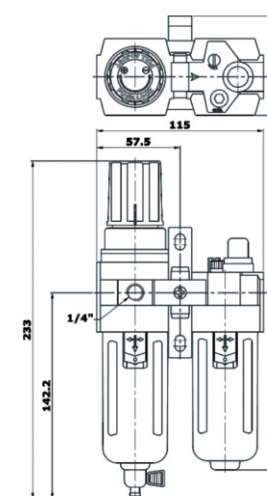

**► Specification**

PART NO.		IAP C502	IAP C503	IAP C504
DESCRIPTION		IAP FRL502	IAP FRL502	IAP FRL504
Medium		Air		
Port Size (G)		1/4"	3/8"	1/2"
Filter Element		5µ		
Max Input Pressure	Psi	215		
	Mpa	1.5		
Max Output Pressure	Psi	7 - 150		
	Mpa	0.05 - 1		
Max Flow (L/min)		2200	3000	3100
Operation Temperature Range		5 ~ 60°C		
Drain Capacity		55ml		
Oil Capacity		80ml		
Recommendable Lubricants		ISO VG-32		
<b>MORE OPTIONS</b>				
Air Filter		IAP F502	IAP F503	IAP F504
Regulator		IAP R502	IAP R503	IAP R504
Air Filter+Regulator		IAP FR502	IAP FR503	IAP FR504
Lubricator		IAP L502	IAP L503	IAP L504

**IAP FRL70**



**70 SERIES DRAWING**

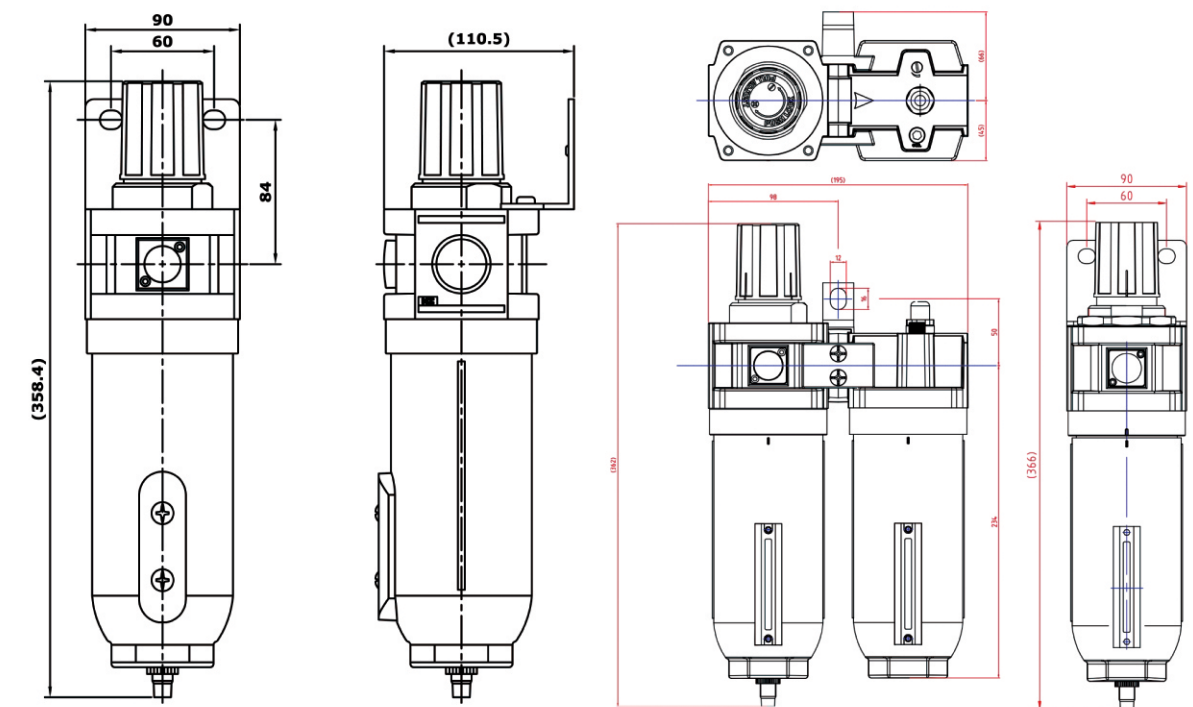

**► Order information**

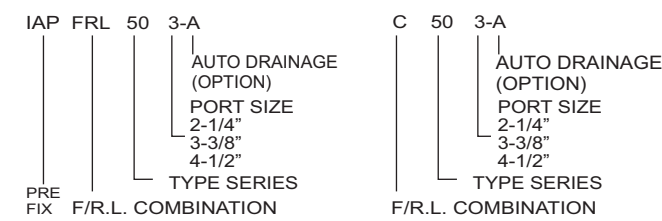

**► Features**

- 1 Steel guards offer better protection.
- 2 Safe Lockable buckles for firm installation.

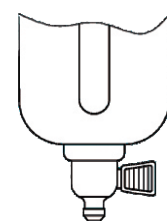

Semi-Auto Drain Valve

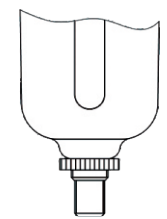

Manual Drain Valve

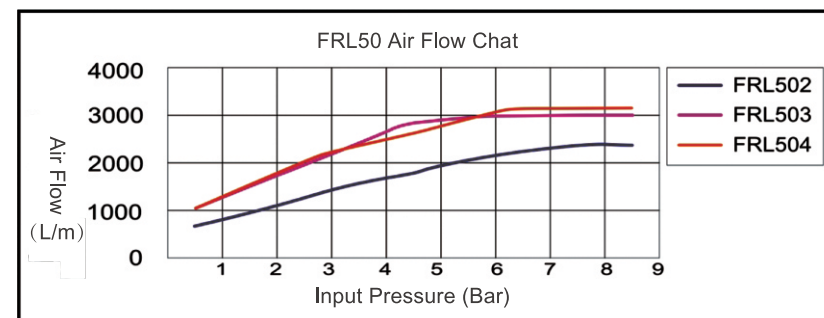



### ► Specification

DESCRIPTION	PART NO.	FRL906	FRL926	FRL908	FRL928	FRL906A	FRL906A	FRL908A	FRL928A
Medium		Air							
Port Size (G)		3/4"		1"		3/4"			1
Filter Element		5µ							
Max Input Pressure	Psi		250					165	
	Mpa		1.7					1.1	
Max Output Pressure	Psi		225					150	
	Mpa		1.6					1	
Max Flow (L/min)		4600		5200		4600			5200
Operation Temperature Range		5°C ~ 60°C							
Drain Capacity		300ml							
Oil Capacity		300ml							
<b>MORE OPTIONS</b>									
Air Filter+Regulator		FR 906	FR 926	FR 908	FR 928	FR 906A	FR 926A	FR 908A	FR 928A

### ► Features

- 1 Heavy duty type – High Air flow and drain capacity.
- 2 Transparent water level indicator for easy checking.
- 3 FRL90 series is suitable for any high flow air pressure equipment or system

### ► Order information

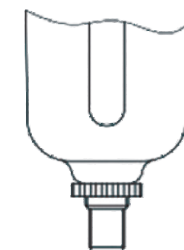
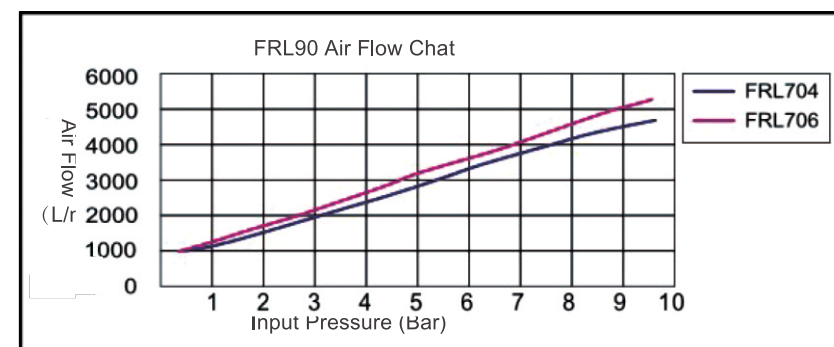
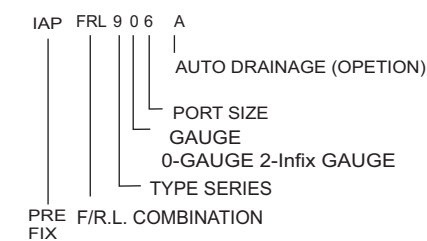

Auto Drain Valve

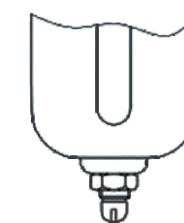

Manual Drain Valve

### COALESCING FILTER / DESICCANT DRYER



IAP F-LM86

IAP - FM86

IAP - LM86

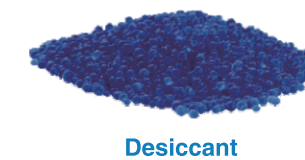

Desiccant



IAP FR - FLM863



# NO.5 Push fitting

## Features

- Available as: Tube fittings, Speed Controllers, Metal Fittings, Hand Valve
- High Resistance
- Light Weight
- 100% Leak Free
- Durability of product & Equipment

## Application

- Leakage free & anti-vibration
- Easy connection and disassembly
- Compact size for any limit space installation
- Pipe rotatable after push-in
- Wide range of working temperature -10°C to 80°C
- Working Pressure Up to 15 bar



## PUSH - TO - CONNECT FITTING

Threaded Straight									
Model	Tube Size	Thread Size	Model	Tube Size	Thread Size	Model	Tube Size	Thread Size	Model
IAPC4-M5	4 MM	M5	IAPC8-02	8 MM	1/4"	IAPC12-03	12 MM	3/8"	
IAPC4-01	4 MM	1/8"	IAPC8-03	8 MM	3/8"	IAPC12-04	12 MM	1/2"	
IAPC4-02	4 MM	1/4"	IAPC8-04	8 MM	1/2"	IAPC14-02	14 MM	1/4"	
IAPC6-M5	6 MM	M5	IAPC10-01	10 MM	1/8"	IAPC14-03	14 MM	3/8"	
IAPC6-01	6 MM	1/8"	IAPC10-02	10 MM	1/4"	IAPC14-04	14 MM	1/2"	
IAPC6-02	6 MM	1/4"	IAPC10-03	10 MM	3/8"	IAPC16-03	16 MM	3/8"	
IAPC6-03	6 MM	3/8"	IAPC10-04	10 MM	1/2"	IAPC16-04	16 MM	1/2"	
IAPC6-04	6 MM	1/2"	IAPC12-01	12 MM	1/8"				
IAPC8-01	8 MM	1/8"	IAPC12-02	12 MM	1/4"				

Hex. Holed Straight									
Model	Tube Size	Thread Size	Model	Tube Size	Thread Size	Model	Tube Size	Thread Size	Model
IAPOC4-M5	4 MM	M5	IAPOC8-01	8 MM	1/8"	IAPOC12-03	12 MM	3/8"	
IAPOC4-01	4 MM	1/8"	IAPOC8-02	8 MM	1/4"	IAPOC12-04	12 MM	1/2"	
IAPOC4-02	4 MM	1/4"	IAPOC8-03	8 MM	3/8"	IAPOC14-02	14 MM	1/4"	
IAPOC6-M5	6 MM	M5	IAPOC8-04	8 MM	1/2"	IAPOC14-03	14 MM	3/8"	
IAPOC6-01	6 MM	1/8"	IAPOC10-01	10 MM	1/8"	IAPOC14-04	14 MM	1/2"	
IAPOC6-02	6 MM	1/4"	IAPOC10-02	10 MM	1/4"	IAPOC16-03	16 MM	3/8"	
IAPOC6-03	6 MM	3/8"	IAPOC10-03	10 MM	3/8"	IAPOC16-04	16 MM	1/2"	
IAPOC6-04	6 MM	1/2"	IAPOC10-04	10 MM	1/2"				

Female Threaded Straight									
Model	Tube Size	Thread Size	Model	Tube Size	Thread Size	Model	Tube Size	Thread Size	Model
IAPCF4-01	4 MM	1/8"	IAPCF8-03	8 MM	3/8"	IAPCF12-04	12 MM	1/2"	
IAPCF4-02	4 MM	1/4"	IAPCF8-04	8 MM	1/2"	IAPCF14-02	14 MM	1/4"	
IAPCF6-01	6 MM	1/8"	IAPCF10-01	10 MM	1/8"	IAPCF14-03	14 MM	3/8"	
IAPCF6-02	6 MM	1/4"	IAPCF10-02	10 MM	1/4"	IAPCF14-04	14 MM	1/2"	
IAPCF6-03	6 MM	3/8"	IAPCF10-03	10 MM	3/8"	IAPCF16-03	16 MM	3/8"	
IAPCF6-04	6 MM	1/2"	IAPCF10-04	10 MM	1/2"	IAPCF16-04	16 MM	1/2"	
IAPCF8-01	8 MM	1/8"	IAPCF12-02	12 MM	1/4"				
IAPCF8-02	8 MM	1/4"	IAPCF12-03	12 MM	3/8"				

Male Elbow									
Model	Tube Size	Thread Size	Model	Tube Size	Thread Size	Model	Tube Size	Thread Size	Model
IAPL4-M5	4 MM	M5	IAPL6-04	6 MM	1/2"	IAPL10-03	10 MM	3/8"	
IAPL4-01	4 MM	1/8"	IAPL8-01	8 MM	1/8"	IAPL10-04	10 MM	1/2"	
IAPL4-02	4 MM	1/4"	IAPL8-02	8 MM	1/4"	IAPL12-02	12 MM	1/4"	
IAPL6-M5	6 MM	M5	IAPL8-03	8 MM	3/8"	IAPL12-03	12 MM	3/8"	
IAPL6-01	6 MM	1/8"	IAPL8-04	8 MM	1/2"	IAPL12-04	12 MM	1/2"	
IAPL6-02	6 MM	1/4"	IAPL10-01	10 MM	1/8"	IAPL16-03	16 MM	3/8"	
IAPL6-03	6 MM	3/8"	IAPL10-02	10 MM	1/4"	IAPL16-04	16 MM	1/2"	

Male Elbow									
Model	Tube Size	Thread Size	Model	Tube Size	Thread Size	Model	Tube Size	Thread Size	Model
IAGPL4-M5	4 MM	M5	IAGPL8-02	8 MM	1/4"	IAGPL12-02	12 MM	1/4"	
IAGPL4-01	4 MM	1/8"	IAGPL8-03	8 MM	3/8"	IAGPL12-03	12 MM	3/8"	
IAGPL4-02	4 MM	1/4"	IAGPL8-04	8 MM	1/2"	IAGPL12-04	12 MM	1/2"	
IAGPL6-M5	6 MM	M5	IAGPL10-01	10 MM	1/8"	IAGPL14-02	14 MM	1/4"	
IAGPL6-01	6 MM	1/8"	IAGPL10-02	10 MM	1/4"	IAGPL14-03	14 MM	3/8"	
IAGPL6-02	6 MM	1/4"	IAGPL10-03	10 MM	3/8"	IAGPL14-04	14 MM	1/2"	
IAGPL6-03	6 MM	3/8"	IAGPL10-04	10 MM	1/2"	IAGPL16-03	16 MM	3/8"	
IAGPL8-01	8 MM	1/8"	IAGPL12-01	12 MM	1/8"	IAGPL16-04	16 MM	1/2"	

Female Buckhead Union									
Model	Tube Size	Thread	Model	Tube Size	Thread	Model	Tube Size	Thread	Model
IAPMF4-01	4 MM	1/8"	IAPMF8-02	8 MM	1/4"	IAPMF12-01	12 MM	1/2"	
IAPMF4-02	4 MM	1/4"	IAPMF8-03	8 MM	3/8"	IAPMF12-02	12 MM	3/8"	
IAPMF4-03	4 MM	3/8"	IAPMF8-04	8 MM	1/2"	IAPMF12-03	12 MM	3/8"	
IAPMF6-01	6 MM	1/8"	IAPMF10-01	10 MM	1/8"	IAPMF12-04	12 MM	1/2"	
IAPMF6-02	6 MM	1/4"	IAPMF10-02	10 MM	1/4"	IAPMF16-03	16 MM	3/8"	
IAPMF6-03	6 MM	3/8"	IAPMF10-03	10 MM	3/8"	IAPMF16-04	16 MM	1/2"	
IAPMF8-01	8 MM	1/8"	IAPMF10-04	10 MM	1/2"				

45° ELBOW									
Model	Tube Size	Thread	Model	Tube Size	Thread	Model	Tube Size	Thread	Model
IAPLH4-M5	4 MM	M5	IAPLH6-04	6 MM	1/2"	IAPLH10-03	10 MM	3/8"	
IAPLH4-01	4 MM	1/8"	IAPLH8-01	8 MM	1/8"	IAPLH10-04	10 MM	1/2"	
IAPLH4-02	4 MM	1/4"	IAPLH8-02	8 MM	1/4"	IAPLH12-01	12 MM	1/8"	
IAPLH6-M5	6 MM	M5	IAPLH8-03	8 MM	3/8"	IAPLH12-02	12 MM	3/8"	
IAPLH6-01	6 MM	1/8"	IAPLH8-04	8 MM	1/2"	IAPLH12-03	12 MM	1/2"	
IAPLH6-02	6 MM	1/4"	IAPLH10-01	10 MM	1/8"	IAPLH12-04	12 MM	3/8"	
IAPLH6-03	6 MM	3/8"	IAPLH10-02	10 MM	1/4"				

Female Elbow									
Model	Tube Size	Thread	Model	Tube Size	Thread	Model	Tube Size	Thread	Model
IAPLF4-M5	4 MM	M5	IAPLF6-04	6 MM	1/2"	IAPLF10-03	10 MM	3/8"	
IAPLF4-01	4 MM	1/8"	IAPLF8-01	8 MM	1/8"	IAPLF10-04	10 MM	1/2"	
IAPLF4-02	4 MM	1/4"	IAPLF8-02	8 MM	1/4"	IAPLF12-02	12 MM	1/4"	
IAPLF6-M5	6 MM	M5	IAPLF8-03	8 MM	3/8"	IAPLF12-03	12 MM	3/8"	
IAPLF6-01	6 MM	1/8"	IAPLF8-04	8 MM	1/2"	IAPLF12-04	12 MM	1/2"	
IAPLF6-02	6 MM	1/4"	IAPLF10-01	10 MM	1/8"	IAPLF16-03	16 MM	3/8"	
IAPLF6-03	6 MM	3/8"	IAPLF10-02	10 MM	1/4"	IAPLF16-04	16 MM	1/2"	



MALE LONG ELBOW								
Model	Tube Size	Thread	Model	Tube Size	Thread	Model	Tube Size	Thread
IAPLL4-M5	4 MM	M5	IAPLL8-01	8 MM	1/8"	IAPLL10-04	10 MM	1/2"
IAPLL4-01	4 MM	1/8"	IAPLL8-02	8 MM	1/4"	IAPLL12-01	12 MM	1/8"
IAPLL4-02	4 MM	1/4"	IAPLL8-03	8 MM	3/8"	IAPLL12-02	12 MM	1/4"
IAPLL6-M5	6 MM	M5	IAPLL8-04	8 MM	1/2"	IAPLL12-03	12 MM	3/8"
IAPLL6-01	6 MM	1/8"	IAPLL10-01	10 MM	1/8"	IAPLL12-04	12 MM	1/2"
IAPLL6-02	6 MM	1/4"	IAPLL10-02	10 MM	1/4"	IAPLL16-03	16 MM	3/8"
IAPLL6-03	6 MM	3/8"	IAPLL10-03	10 MM	3/8"	IAPLL16-04	16 MM	1/2"
IAPLL6-04	6 MM	1/2"						

BRANCH TEE								
Model	Tube Size	Thread	Model	Tube Size	Thread	Model	Tube Size	Thread
IAGPB4-M5	4 MM	M5	IAGPB6-04	6 MM	1/2"	IAGPB10-03	10 MM	3/8"
IAGPB4-01	4 MM	1/8"	IAGPB8-01	8 MM	1/8"	IAGPB10-04	10 MM	1/2"
IAGPB4-02	4 MM	1/4"	IAGPB8-02	8 MM	1/4"	IAGPB12-02	12 MM	1/4"
IAGPB6-M5	6 MM	M5	IAGPB8-03	8 MM	3/8"	IAGPB12-03	12 MM	3/8"
IAGPB6-01	6 MM	1/8"	IAGPB8-04	8 MM	1/2"	IAGPB12-04	12 MM	1/2"
IAGPB6-02	6 MM	1/4"	IAGPB10-01	10 MM	1/8"	IAGPB16-03	16 MM	3/8"
IAGPB6-03	6 MM	3/8"	IAGPB10-02	10 MM	1/4"	IAGPB16-04	16 MM	1/2"

Male Union Y								
Model	Tube Size	Thread	Model	Tube Size	Thread	Model	Tube Size	Thread
IAPX4-M5	4 MM	M5	IAPX8-01	8 MM	1/8"	IAPX10-04	10 MM	1/2"
IAPX4-01	4 MM	1/8"	IAPX8-02	8 MM	1/4"	IAPX12-01	12 MM	1/8"
IAPX4-02	4 MM	1/4"	IAPX8-03	8 MM	3/8"	IAPX12-02	12 MM	1/4"
IAPX6-M5	6 MM	M5	IAPX8-04	8 MM	1/2"	IAPX12-03	12 MM	3/8"
IAPX6-01	6 MM	1/8"	IAPX10-01	10 MM	1/8"	IAPX12-04	12 MM	1/2"
IAPX6-02	6 MM	1/4"	IAPX10-02	10 MM	1/4"	IAPX16-03	16 MM	3/8"
IAPX6-03	6 MM	3/8"	IAPX10-03	10 MM	3/8"	IAPX16-04	16 MM	1/2"
IAPX6-04	6 MM	1/2"						

Female Universal Elbow								
Model	Tube Size	Thread	Model	Tube Size	Thread	Model	Tube Size	Thread
IAPHF4-M5	4 MM	M5	IAPHF6-04	6 MM	1/2"	IAPHF10-02	10 MM	1/4"
IAPHF4-01	4 MM	1/8"	IAPHF8-01	8 MM	1/8"	IAPHF10-03	10 MM	3/8"
IAPHF4-02	4 MM	1/4"	IAPHF8-02	8 MM	1/4"	IAPHF10-04	10 MM	1/2"
IAPHF6-M5	6 MM	M5	IAPHF8-03	8 MM	3/8"	IAPHF12-02	12 MM	1/4"
IAPHF6-01	6 MM	1/8"	IAPHF8-04	8 MM	1/2"	IAPHF12-03	12 MM	3/8"
IAPHF6-02	6 MM	1/4"	IAPHF10-01	10 MM	1/8"	IAPHF12-04	12 MM	1/2"
IAPHF6-03	6 MM	3/8"						

UNIVERSAL ELBOW			Pipe type throttle valve		
Model	Tube Size	Thread	Model	Tube Size	Thread
IAPH4-M5	4 MM	M5	IAPH8-02	8 MM	1/4"
IAPH4-01	4 MM	1/8"	IAPH8-03	8 MM	3/8"
IAPH6-M5	6 MM	M5	IAPH8-04	8 MM	1/2"
IAPH6-01	6 MM	1/8"	IAPH10-02	10 MM	1/4"
IAPH6-02	6 MM	1/4"	IAPH10-03	10 MM	3/8"
IAPH6-03	6 MM	3/8"	IAPH10-04	10 MM	1/2"
IAPH8-01	8 MM	1/8"	IAPH12-03	12 MM	3/8"
IAPH8-02	8 MM	1/4"	IAPH12-04	12 MM	1/2"

BRANCH TRIPLE			Reduced Branch Triple			
Model	Tube Size	Thread	Model	Tube Size	Thread	Unit Price
IAPKB04-01	4 MM	1/8"	IAPKD6-4-01	6 MM-4 MM	1/8"	126
IAPKB04-02	4 MM	1/4"	IAPKD8-4-02	8 MM-4 MM	1/4"	160
IAPKB06-01	6 MM	1/8"	IAPKD8-6-02	8 MM-6 MM	1/4"	165
IAPKB06-02	6 MM	1/4"	IAPKD10-8-03	10 MM-8 MM	3/8"	235
IAPKB06-03	6 MM	3/8"				
IAPKB08-01	8 MM	1/8"				
IAPKB08-02	8 MM	1/4"				
IAPKB08-03	8 MM	3/8"				

DOUBLE Y BRANCH TRIPLE			Union Y		Union Y	
Model	Tube Size	Thread	Model	Size	Model	Size
IAPRX04-M5	4 MM	M5	IAPY04	4 MM	IAPY04	4 MM
IAPRX04-01	4 MM	1/8"	IAPY06	6 MM	IAPY06	6 MM
IAPRX06-M5	6 MM	M5	IAPY08	8 MM	IAPY08	8 MM
IAPRX06-01	6 MM	1/8"	IAPY10	10 MM	IAPY10	10 MM
IAPRX06-02	6 MM	1/4"	IAPY12	12 MM	IAPY12	12 MM

Bulkhead Union		Plastic Bulkhead Union		45° Socket Elbow	
Model	Size	Model	Size	MODEL	Size
IAPM4	4 MM	IAPMP4	4 MM	IAPLH4	4 MM
IAPM6	6 MM	IAPMP6	6 MM	IAPLH6	6 MM
IAPM8	8 MM	IAPMP8	8 MM	IAPLH8	8 MM
IAPM10	10 MM	IAPMP10	10 MM	IAPLH10	10 MM
IAPM12	12 MM	IAPMP12	12 MM	IAPLH12	12 MM
IAPM14	14 MM				
IAPM16	16 MM				

BRANCH Y ELBOW					
Model	Tube Size	Thread	Model	Tube Size	Thread
IAPAX04-M5	4 MM	M5	IAPAX08-04	8 MM	1/2"
IAPAX04-01	4 MM	1/8"	IAPAX10-01	10 MM	1/8"
IAPAX06-M5	6 MM	M5	IAPAX10-02	10 MM	1/4"
IAPAX06-01	6 MM	1/8"	IAPAX10-03	10 MM	3/8"
IAPAX06-02	6 MM	1/4"	IAPAX10-04	10 MM	1/2"
IAPAX06-03	6 MM	3/8"	IAPAX12-02	12 MM	1/4"
IAPAX08-01	8 MM	1/8"	IAPAX12-03	12 MM	3/8"
IAPAX08-02	8 MM	1/4"	IAPAX12-04	12 MM	1/2"
IAPAX08-03	8 MM	3/8"			

Socket Elbow	
MODEL	Size
IAPL4	4 MM
IAPL6	6 MM
IAPL8	8 MM
IAPL10	10 MM
IAPL12	12 MM

Diff. Diam Union Y		ELBOW		TEE	
MODEL	Size	Model	Size	Model	Size
IAPWJ6-4	6 MM-4 MM	IAPV4	APV4	IAPE4	4 MM
IAPWJ8-6	8 MM-6 MM	IAPV6	APV6	IAPE6	6 MM
IAPWJ10-8	10 MM-8 MM	IAPV8	APV8	IAPE8	8 MM
IAPWJ12-10	12 MM-10 MM	IAPV10	APV10	IAPE10	10 MM
		IAPV12	APV12	IAPE12	12 MM
		IAPV14	APV14	IAPE14	14 MM
		IAPV16	APV16	IAPE16	16 MM

STRAIGHT		REDUCER STRAIGHT		REDUCED TEE A	
Model	Size	Model	Size	Model	Size
IAPG6-4	4 MM	IAPG6-4	6 MM-4 MM	IAPEG6-4	6 MM-4 MM
IAPU6	6 MM	IAPG8-6	8 MM-6 MM	IAPEG8-6	8 MM-6 MM
IAPU8	8 MM	IAPG10-8	10 MM-8 MM	IAPEG10-8	10 MM-8 MM
IAPU10	10 MM	IAPG12-10	12 MM-10 MM	IAPEG12-10	12 MM-10 MM
IAPU12	12 MM	IAPG14-12	14 MM-12 MM	IAPEG14-12	14 MM-12 MM
IAPU14	14 MM	IAPG16-14	16 MM-14 MM	IAPEG16-12	16 MM-12 MM
IAPU16	16 MM			IAPEG16-14	16 MM-14 MM

UNIION Y		REDUCED UNION Y		BRANCH Y ELBOW	
Model	Size	Model	Size	Model	Size
IAPY4	4 MM	IAPW6-4	6 MM-4 MM	IAPAU4	4 MM
IAPY6	6 MM	IAPW8-6	8 MM-6 MM	IAPAU6	6 MM
IAPY8	8 MM	IAPW10-8	10 MM-8MM	IAPAU8	8 MM
IAPY10	10 MM	IAPW12-10	12 MM-10 MM	IAPAU10	10 MM
IAPY12	12 MM	IAPW14-12	14 MM-12 MM	IAPAU12	12 MM
IAPY14	14 MM	IAPW16-12	16 MM-12 MM		
IAPY16	16 MM				

Angle Tee		CROSS		REDUCER	
Model	Size	Model	Ordering Code	Model	Size
IAPV4	4 MM	IAPZ44	4 MM	IAPG6-4	6 MM-4 MM
IAPV6	6 MM	IAPZ66	6 MM	IAPG8-4	8 MM-4 MM
IAPV8	8 MM	IAPZ88	8 MM	IAPG8-6	8 MM-6 MM
IAPV10	10 MM	IAPZ1010	10 MM	IAPG10-6	10 MM-6 MM
IAPV12	12 MM	IAPZ1212	12 MM	IAPG10-8	10 MM-8 MM
				IAPG12-6	12 MM-6 MM
				IAPG12-8	12 MM-8 MM
				IAPG12-10	12 MM-10 MM

CARTRIDGE		INSERT TUBE		PLUG	
Model	Size	Model	Size	Model	Size
IACAS04	4 MM	IACAS04	4 MM	IAPP4	4 MM
IACAS06	6 MM	IACAS06	6 MM	IAPP6	6 MM
IACAS08	8 MM	IACAS08	8 MM	IAPP8	8 MM
IACAS10	10 MM	IACAS10	10 MM	IAPP10	10 MM
IACAS12	12 MM	IACAS12	12 MM	IAPP12	12 MM
IACAS16	16 MM	IACAS16	16 MM		

TUBE CAP		REDUCER TUBE SPICER		The screwdriver adjustment throttle valve	
Model	Size	Model	Size	MODEL	Size
IAPPF04	4 MM	IAPIG06-04	6 MM-4 MM	IASL4-G01-DC	4 MM X 1/8"
IAPPF06	6 MM	IAPIG08-04	8 MM-4 MM	IASL4-G02-DC	4 MM X 1/4"
IAPPF08	8 MM	IAPIG08-06	8 MM-6 MM	IASL6-G01-DC	6 MM X 1/8"
IAPPF10	10 MM	IAPIG10-06	10 MM-6 MM	IASL6-G02-DC	6 MM X 1/4"
IAPPF12	12 MM	IAPIG10-08	10 MM-8 MM	IASL8-G01-DC	8 MM X 1/8"
		IAPIG12-08	12 MM-8 MM	IASL8-G02-DC	8 MM X 1/4"
		IAPIG12-10	12 MM-10 MM	IASL10-G01-DC	10 MM X 1/8"
		IAPIG16-12	16 MM-12 MM	IASL10-G02-DC	10 MM X 1/4"
				IASL12-G02-DC	12 MM X 1/4"

Speed Controller-Elbow							
Control Out	Control In	Size	Thread	Control Out	Control In	Size	Thread
IASL4-M5	IASL4-M5B	4 MM	M5	IASL8-03	IASL8-03B	8 MM	3/8"
IASL4-01	IASL4-01B	4 MM	1/8"	IASL8-04	IASL8-04B	8 MM	1/2"
IASL4-02	IASL4-02B	4 MM	1/4"	IASL10-01	IASL10-01B	10 MM	1/8"
IASL6-M5	IASL6-M5B	6 MM	M5	IASL10-02	IASL10-02B	10 MM	1/4"
IASL6-01	IASL6-01B	6 MM	1/8"	IASL10-03	IASL10-03B	10 MM	3/8"
IASL6-02	IASL6-02B	6 MM	1/4"	IASL10-04	IASL10-04B	10 MM	1/2"
IASL6-03	IASL6-03B	6 MM	3/8"	IASL12-02	IASL12-02B	12 MM	1/4"
IASL6-04	IASL6-04B	6 MM	1/2"	IASL12-03	IASL12-03B	12 MM	3/8"
IASL8-01	IASL8-01B	8 MM	1/8"	IASL12-04	IASL12-04B	12 MM	1/2"
IASL8-02	IASL8-02B	8 MM	1/4"				

Speed Controller-Elbow HIGH FLOW				Mini Speed Controller-Elbow throttle			
Control Out	Control In	Size	Thread	CONTROL OUT	CONTROL IN	Size	Thread
IASLH8-01	IASLH8-01B	8 MM	1/8"	IASL3-M3C	IASL3-M3BC	3 MM	M3
IASLH8-02	IASLH8-02B	8 MM	1/4"	IASL3-M5C	IASL3-M5BC	3 MM	M5
				IASL4-M3C	IASL4-M3BC	4 MM	M3
				IASL4-M5C	IASL4-M5BC	4 MM	M5
				IASL6-M5C	IASL6-M5BC	6 MM	M5

Union Straight Valve			
MODEL			Size
Two-way	Three-way		
IAHVFF06-06B	IAHVFF06-06		6 MM
IAHVFF08-06B	IAHVFF08-06		8 MM-6 MM
IAHVFF08-08B	IAHVFF08-08		8 MM
IAHVFF10-10B	IAHVFF10-10		10 MM
IAHVFF12-10B	IAHVFF12-10		12 MM-10MM
IAHVFF12-12B	IAHVFF12-12		12 MM

Thread-Thread Straight Valve			
Two-way		Three-way	
Model	Model	Model	Size
IAHVSS01-01B	IAHVSS01-01		1/8"x1/8"
IAHVSS02-01B	IAHVSS02-01		1/4"x1/8"
IAHVSS02-02B	IAHVSS02-02		1/4"x1/4"
IAHVSS03-02B	IAHVSS03-02		3/8"x1/4"
IAHVSS03-03B	IAHVSS03-03		3/8"x3/8"
IAHVSS04-03B	IAHVSS04-03		1/2"x3/8"
IAHVSS04-04B	IAHVSS04-04		1/2"x1/2"

Thread-Fitting Straight Valve			
MODEL		Size	MODEL
Two-way	Three-way		
IAHVSF01-06B	IAHVSF01-06	1/8" X 6 MM	IAHVSF02-10B
IAHVSF02-06B	IAHVSF02-06	1/4" X 6 MM	IAHVSF03-10B
IAHVSF03-06B	IAHVSF03-06	3/8" X 6 MM	IAHVSF04-10B
IAHVSF01-08B	IAHVSF01-08	1/8" X 8 MM	IAHVSF02-12B
IAHVSF02-08B	IAHVSF02-08	1/4" X 8 MM	IAHVSF03-12B
IAHVSF03-08B	IAHVSF03-08	3/8" X 8 MM	IAHVSF04-12B

Check Valve Elbow		
MODEL	Tube Size	Thread
IAPCVL4-M5	4 MM	M5
IAPCVL4-M6	4 MM	M6
IAPCVL4-01	4 MM	1/8"
IAPCVL6-01	6 MM	1/8"
IAPCVL6-02	6 MM	1/4"

Check Valve Straight					
MODEL	Tube Size	Thread	MODEL	Tube Size	Thread
IAPCVC4-M5	4 MM	M5	IAPCVC8-01	8 MM	1/8"
IAPCVC4-M6	4 MM	M6	IAPCVC8-02	8 MM	1/4"
IAPCVC4-01	4 MM	1/8"	IAPCVC10-03	10 MM	3/8"
IAPCVC6-01	6 MM	1/8"	IAPCVC10-04	10 MM	1/2"
IAPCVC6-02	6 MM	1/4"	IAPCVC12-03	12 MM	3/8"
			IAPCVC12-04	12 MM	1/2"

MODEL	Tube Size	Thread	MODEL	Tube Size	Thread
IAPCVL4-M5	4 MM	M5	IAPCVL8-01	8 MM	1/8"
IAPCVL4-M6	4 MM	M6	IAPCVL8-02	8 MM	1/4"
IAPCVL4-01	4 MM	1/8"	IAPCVL10-03	10 MM	3/8"
IAPCVL6-01	6 MM	1/8"	IAPCVL10-04	10 MM	1/2"
IAPCVL6-02	6 MM	1/4"	IAPCVL12-03	12 MM	3/8"
			IAPCVL12-04	12 MM	1/2"

## METAL FITTING

Male Threaded Straight								
Model	Tube Size	Thread Size	Model	Tube Size	Thread Size	Model	Tube Size	Thread Size
IAMPC4-G01	4 MM	1/8"	IAMPC8-G02	8 MM	1/4"	IAMPC12-G01	12 MM	1/8"
IAMPC4-G02	4 MM	1/4"	IAMPC8-G03	8 MM	3/8"	IAMPC12-G02	12 MM	1/4"
IAMPC6-G01	6 MM	1/8"	IAMPC8-G04	8 MM	1/2"	IAMPC12-G03	12 MM	3/8"
IAMPC6-G02	6 MM	1/4"	IAMPC10-G01	10 MM	1/8"	IAMPC12-G04	12 MM	1/2"
IAMPC6-G03	6 MM	3/8"	IAMPC10-G02	10 MM	1/4"	IAMPC16-G03	16 MM	3/8"
IAMPC6-G04	6 MM	1/2"	IAMPC10-G03	10 MM	3/8"	IAMPC16-G04	16 MM	1/2"
IAMPC8-G01	8 MM	1/8"	IAMPC10-G04	10 MM	1/2"			

Male Elbow								
Model	Tube Size	Thread Size	Model	Tube Size	Thread Size	Model	Tube Size	Thread Size
IAMPL4-G01	4 MM	1/8"	IAMPL8-G02	8 MM	1/4"	IAMPL12-G01	12 MM	1/8"
IAMPL4-G02	4 MM	1/4"	IAMPL8-G03	8 MM	3/8"	IAMPL12-G02	12 MM	1/4"
IAMPL6-G01	6 MM	1/8"	IAMPL8-G04	8 MM	1/2"	IAMPL12-G03	12 MM	3/8"
IAMPL6-G02	6 MM	1/4"	IAMPL10-G01	10 MM	1/8"	IAMPL12-G04	12 MM	1/2"
IAMPL6-G03	6 MM	3/8"	IAMPL10-G02	10 MM	1/4"	IAMPL16-G03	16 MM	3/8"
IAMPL6-G04	6 MM	1/2"	IAMPL10-G03	10 MM	3/8"	IAMPL16-G04	16 MM	1/2"
IAMPL8-G01	8 MM	1/8"	IAMPL10-G04	10 MM	1/2"			

Male Tee								
Model	Tube Size	Thread Size	Model	Tube Size	Thread Size	Model	Tube Size	Thread Size
IAMPB4-G01	4 MM	1/8"	IAMPB8-G02	8 MM	1/4"	IAMPB12-G01	12 MM	1/8"
IAMPB4-G02	4 MM	1/4"	IAMPB8-G03	8 MM	3/8"	IAMPB12-G02	12 MM	1/4"
IAMPB6-G01	6 MM	1/8"	IAMPB8-G04	8 MM	1/2"	IAMPB12-G03	12 MM	3/8"
IAMPB6-G02	6 MM	1/4"	IAMPB10-G01	10 MM	1/8"	IAMPB12-G04	12 MM	1/2"
IAMPB6-G03	6 MM	3/8"	IAMPB10-G02	10 MM	1/4"	IAMPB16-G03	16 MM	3/8"
IAMPB6-G04	6 MM	1/2"	IAMPB10-G03	10 MM	3/8"	IAMPB16-G04	16 MM	1/2"
IAMPB8-G01	8 MM	1/8"	IAMPB10-G04	10 MM	1/2"			

Branch Tee								
Model	Tube Size	Thread Size	Model	Tube Size	Thread Size	Model	Tube Size	Thread Size
IAMPD4-G01	4 MM	1/8"	IAMPD8-G02	8 MM	1/4"	IAMPD12-G01	12 MM	1/8"
IAMPD4-G02	4 MM	1/4"	IAMPD8-G03	8 MM	3/8"	IAMPD12-G02	12 MM	1/4"
IAMPD6-G01	6 MM	1/8"	IAMPD8-G04	8 MM	1/2"	IAMPD12-G03	12 MM	3/8"
IAMPD6-G02	6 MM	1/4"	IAMPD10-G01	10 MM	1/8"	IAMPD12-G04	12 MM	1/2"
IAMPD6-G03	6 MM	3/8"	IAMPD10-G02	10 MM	1/4"	IAMPD16-G03	16 MM	3/8"
IAMPD6-G04	6 MM	1/2"	IAMPD10-G03	10 MM	3/8"	IAMPD16-G04	16 MM	1/2"
IAMPD8-G01	8 MM	1/8"	IAMPD10-G04	10 MM	1/2"			

Single Universal Elbow								
Model	Tube Size	Thread Size	Model	Tube Size	Thread Size	Model	Tube Size	Thread Size
IAMPGL4-G01-1	4 MM	1/8"	IAMPGL8-G02-1	8 MM	1/4"	IAMPGL12-G02-1	12 MM	1/4"
IAMPGL4-G02-1	4 MM	1/4"	IAMPGL8-G03-1	8 MM	3/8"	IAMPGL12-G03-1	12 MM	3/8"
IAMPGL6-G01-1	6 MM	1/8"	IAMPGL8-G04-1	8 MM	1/2"	IAMPGL12-G04-1	12 MM	1/2"
IAMPGL6-G02-1	6 MM	1/4"	IAMPGL10-G01-1	10 MM	1/8"	IAMPGL16-G03-1	16 MM	3/8"
IAMPGL6-G03-1	6 MM	3/8"	IAMPGL10-G02-1	10 MM	1/4"	IAMPGL16-G04-1	16 MM	1/2"
IAMPGL6-G04-1	6 MM	1/2"	IAMPGL10-G03-1	10 MM	3/8"			
IAMPGL8-G01-1	8 MM	1/8"	IAMPGL10-G04-1	10 MM	1/2"			

Double Universal Elbow								
Model	Tube Size	Thread Size	Model	Tube Size	Thread Size	Model	Tube Size	Thread Size
IAMPGL4-G01-2	4 MM	1/8"	IAMPGL8-G02-2	8 MM	1/4"	IAMPGL12-G02-2	12 MM	1/4"
IAMPGL4-G02-2	4 MM	1/4"	IAMPGL8-G03-2	8 MM	3/8"	IAMPGL12-G03-2	12 MM	3/8"
IAMPGL6-G01-2	6 MM	1/8"	IAMPGL8-G04-2	8 MM	1/2"	IAMPGL12-G04-2	12 MM	1/2"
IAMPGL6-G02-2	6 MM	1/4"	IAMPGL10-G01-2	10 MM	1/8"	IAMPGL16-G03-2	16 MM	3/8"
IAMPGL6-G03-2	6 MM	3/8"	IAMPGL10-G02-2	10 MM	1/4"	IAMPGL16-G04-2	16 MM	1/2"
IAMPGL6-G04-2	6 MM	1/2"	IAMPGL10-G03-2	10 MM	3/8"			
IAMPGL8-G01-2	8 MM	1/8"	IAMPGL10-G04-2	10 MM	1/2"			

Triple Universal Elbow								
Model	Tube Size	Thread Size	Model	Tube Size	Thread Size	Model	Tube Size	Thread Size
IAMPGL4-G01-3	4 MM	1/8"	IAMPGL8-G02-3	8 MM	1/4"	IAMPGL12-G02-3	12 MM	1/4"
IAMPGL4-G02-3	4 MM	1/4"	IAMPGL8-G03-3	8 MM	3/8"	IAMPGL12-G03-3	12 MM	3/8"
IAMPGL6-G01-3	6 MM	1/8"	IAMPGL8-G04-3	8 MM	1/2"	IAMPGL12-G04-3	12 MM	1/2"
IAMPGL6-G02-3	6 MM	1/4"	IAMPGL10-G01-3	10 MM	1/8"	IAMPGL16-G03-3	16 MM	3/8"
IAMPGL6-G03-3	6 MM	3/8"	IAMPGL10-G02-3	10 MM	1/4"	IAMPGL16-G04-3	16 MM	1/2"
IAMPGL6-G04-3	6 MM	1/2"	IAMPGL10-G03-3	10 MM	3/8"			
IAMPGL8-G01-3	8 MM	1/8"	IAMPGL10-G04-3	10 MM	1/2"			

Single Banjo								
Model	Tube Size	Thread Size	Model	Tube Size	Thread Size	Model	Tube Size	Thread Size
IAMPGL4-01P	4 MM	1/8"	IAMPGL8-02P	8 MM	1/4"	IAMPGL12-03P	12 MM	3/8"
IAMPGL4-02P	4 MM	1/4"	IAMPGL8-03P	8 MM	3/8"	IAMPGL12-04P	12 MM	1/2"
IAMPGL6-01P	6 MM	1/8"	IAMPGL8-04P	8 MM	1/2"	IAMPGL16-03P	16 MM	3/8"
IAMPGL6-02P	6 MM	1/4"	IAMPGL10-02P	10 MM	1/4"	IAMPGL16-04P	16 MM	1/2"
IAMPGL6-03P	6 MM	3/8"	IAMPGL10-03P	10 MM	3/8"			
IAMPGL6-04P	6 MM	1/2"	IAMPGL10-04P	10 MM	1/2"			
IAMPGL8-01P	8 MM	1/8"	IAMPGL12-02P	12 MM	1/4"			

Double Banjo								
Model	Tube Size	Thread Size	Model	Tube Size	Thread Size	Model	Tube Size	Thread Size
IAMPGT4-01P	4 MM	1/8"	IAMPGT8-02P	8 MM	1/4"	IAMPGT12-01P	12 MM	1/8"
IAMPGT4-02P	4 MM	1/4"	IAMPGT8-03P	8 MM	3/8"	IAMPGT12-02P	12 MM	1/4"
IAMPGT6-01P	6 MM	1/8"	IAMPGT8-04P	8 MM	1/2"	IAMPGT12-03P	12 MM	3/8"
IAMPGT6-02P	6 MM	1/4"	IAMPGT10-01P	10 MM	1/8"	IAMPGT12-04P	12 MM	1/2"
IAMPGT6-03P	6 MM	3/8"	IAMPGT10-02P	10 MM	1/4"	IAMPGT16-03P	16 MM	3/8"
IAMPGT6-04P	6 MM	1/2"	IAMPGT10-03P	10 MM	3/8"	IAMPGT16-04P	16 MM	1/2"
IAMPGT8-01P	8 MM	1/8"	IAMPGT10-04P	10 MM	1/2"			

Double Universal Tee								
Model	Tube Size	Thread Size	Model	Tube Size	Thread Size	Model	Tube Size	Thread Size
IAMPGT04-G01-1	4 MM	1/8"	IAMPGT08-G02-1	8 MM	1/4"	IAMPGT12-G01-1	12 MM	1/8"
IAMPGT04-G02-1	4 MM	1/4"	IAMPGT08-G03-1	8 MM	3/8"	IAMPGT12-G02-1	12 MM	1/4"
IAMPGT06-G01-1	6 MM	1/8"	IAMPGT08-G04-1	8 MM	1/2"	IAMPGT12-G03-1	12 MM	3/8"
IAMPGT06-G02-1	6 MM	1/4"	IAMPGT10-G01-1	10 MM	1/8"	IAMPGT12-G04-1	12 MM	1/2"
IAMPGT06-G03-1	6 MM	3/8"	IAMPGT10-G02-1	10 MM	1/4"	IAMPGT16-G03-1	16 MM	3/8"
IAMPGT06-G04-1	6 MM	1/2"	IAMPGT10-G03-1	10 MM	3/8"	IAMPGT16-G04-1	16 MM	1/2"
IAMPGT08-G01-1	8 MM	1/8"	IAMPGT10-G04-1	10 MM	1/2"			

Double Universal Tee								
Model	Tube Size	Thread Size	Model	Tube Size	Thread Size	Model	Tube Size	Thread Size
IAMPGT04-G01-2	4 MM	1/8"	IAMPGT08-G02-2	8 MM	1/4"	IAMPGT12-G01-2	12 MM	1/8"
IAMPGT04-G02-2	4 MM	1/4"	IAMPGT08-G03-2	8 MM	3/8"	IAMPGT12-G02-2	12 MM	1/4"
IAMPGT06-G01-2	6 MM	1/8"	IAMPGT08-G04-2	8 MM	1/2"	IAMPGT12-G03-2	12 MM	3/8"
IAMPGT06-G02-2	6 MM	1/4"	IAMPGT10-G01-2	10 MM	1/8"	IAMPGT12-G04-2	12 MM	1/2"
IAMPGT06-G03-2	6 MM	3/8"	IAMPGT10-G02-2	10 MM	1/4"	IAMPGT16-G03-2	16 MM	3/8"
IAMPGT06-G04-2	6 MM	1/2"	IAMPGT10-G03-2	10 MM	3/8"	IAMPGT16-G04-2	16 MM	1/2"
IAMPGT08-G01-2	8 MM	1/8"	IAMPGT10-G04-2	10 MM	1/2"			

Triple Universal Tee								
Model	Tube Size	Thread Size	Model	Tube Size	Thread Size	Model	Tube Size	Thread Size
IAMPGT04-G01-3	4 MM	1/8"	IAMPGT08-G02-3	8 MM	1/4"	IAMPGT12-G01-3	12 MM	1/8"
IAMPGT04-G02-3	4 MM	1/4"	IAMPGT08-G03-3	8 MM	3/8"	IAMPGT12-G02-3	12 MM	